

SSi Hydraulic Low Power Unit

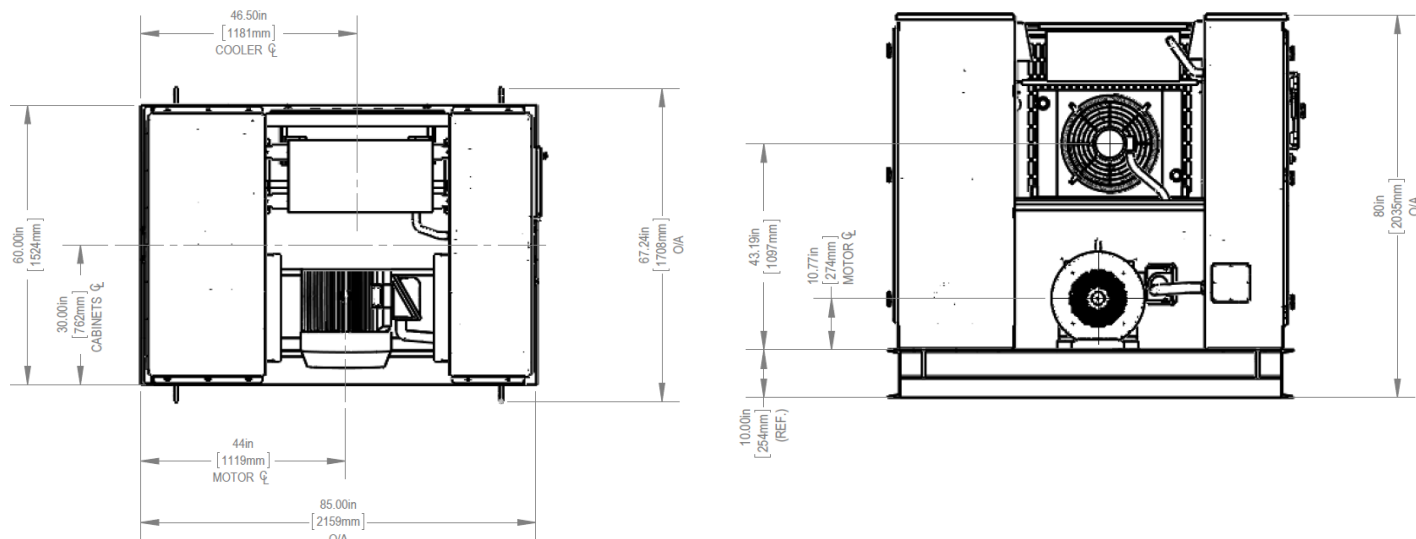

SSi Artificial Lift offers multiple horsepower options per Pumping Unit model ranging from 25 Hp. to 200 Hp. The Power Unit provides the driving force and control for the Pumping Unit. It is comprised of a hydraulic system, variable speed drive (VSD) control and a computer control system (PLC). The system utilizes many sensor mechanisms to provide optimum stroke control and full monitoring of well and pump conditions. The self-monitoring system provides warnings of impending failure conditions, both at the surface and down-hole, and stops the pump prior to a catastrophic failure. The system includes a sealed hydraulic reservoir and various valves for precise control of the cylinder throughout the pumping cycle. The Power Unit is connected to the Pumping Unit by means of high-pressure hoses and electronic control circuitry. The electronics include computer controls that allow for the pump to be controlled by closed loop feedback for precise operation of stroke speed and position. Software upgrades that are completely interchangeable result in equipment that does not get obsoleted.

Specifications

Voltage:	480 V AC 3 Phase
Frequency:	50 or 60 Hz
Minimum Operating Temperature:	-40 °C
Maximum Operating Temperature:	50 °C
Variable Speed Drive:	Integrated
Pump Off Controller:	Integrated

Specifications by Power Unit Model

Model	Weight	Width	Length	Height
25 HP	3625 lbs	67.24"	85"	80"
40 HP	3750 lbs	67.24"	85"	80"
60 HP	3900 lbs	67.24"	85"	80"
75 HP	4150 lbs	67.24"	85"	80"

Important Notice

This datasheet contains typical information specific to products manufactured at the time of its publication.
©SSi Lift CDA (2019) Ltd - Contents herein do not constitute a warranty.